

Feature :

- Small size
- Full color LED illuminated available
- Long electrical life cycles
- SMT and vertical PCB terminal

Application :

- Consumer products
- Computer products
- Instrumentation
- Communication equipments



| SWITCH SPECIFICATIONS       |   |
|-----------------------------|---|
| POLE - POSITION             | Momentary action , SPST                                 |
| CONTACT RATING              | 12 V DC , 5 mA (MAX.)                                   |
| CONTACT RESISTANCE          | 200 Ω MAX. 5 V DC ; 1 mA ,<br>by Method of Voltage DROP |
| INSULATION RESISTANCE       | 100 MΩ MIN. 100 V DC for 1 minute                       |
| DIELECTRIC STRENGTH         | Breakdown is not Allowable ;<br>250 V AC for 1 Minute   |
| OPERATING FORCE             | 80 ± 40 gf  |
| OPERATING LIFE              | 300,000 cycles  |
| OPERATING TEMPERATURE RANGE | -40°C ~ 85°C  |
| TOTAL TRAVEL                | 0.8 <sup>+0.4</sup> <sub>-0.2</sub> mm                  |

| LED SPECIFICATIONS   |      |                   |               |      |        |        |       |       |
|--|------|-------------------|---------------|------|--------|--------|-------|-------|
| ATTENTION<br>LEDs are Electrostatic<br>Sensitive devices<br><br>(+) (-) | Unit | Value / LED Color |               |      |        |        |       |       |
|  |      | Blue<br>(5mA)     | Pure<br>Green | Red  | Yellow | Orange | Green | White |
| LUMINOUS INTENSITY@20mA<br>Iv  | mcd  | 25                | 180           | 200  | 200    | 250    | 55    | 250   |
| Dominant Wavelength<br>λD  | nm   | 470               | 525           | 630  | 590    | 601    | 567   | /     |
| FORWARD VOLTAGE@20mA<br>Vf   | V    | 2.8               | 3.2           | 1.95 | 2      | 2.1    | 2.1   | 4     |

■ A single bin cannot be ordered, please contact us in advance if you need a particular bin sorting before placing your order to clarify the lead time, MOQ and pricing

**HOW TO ORDER**

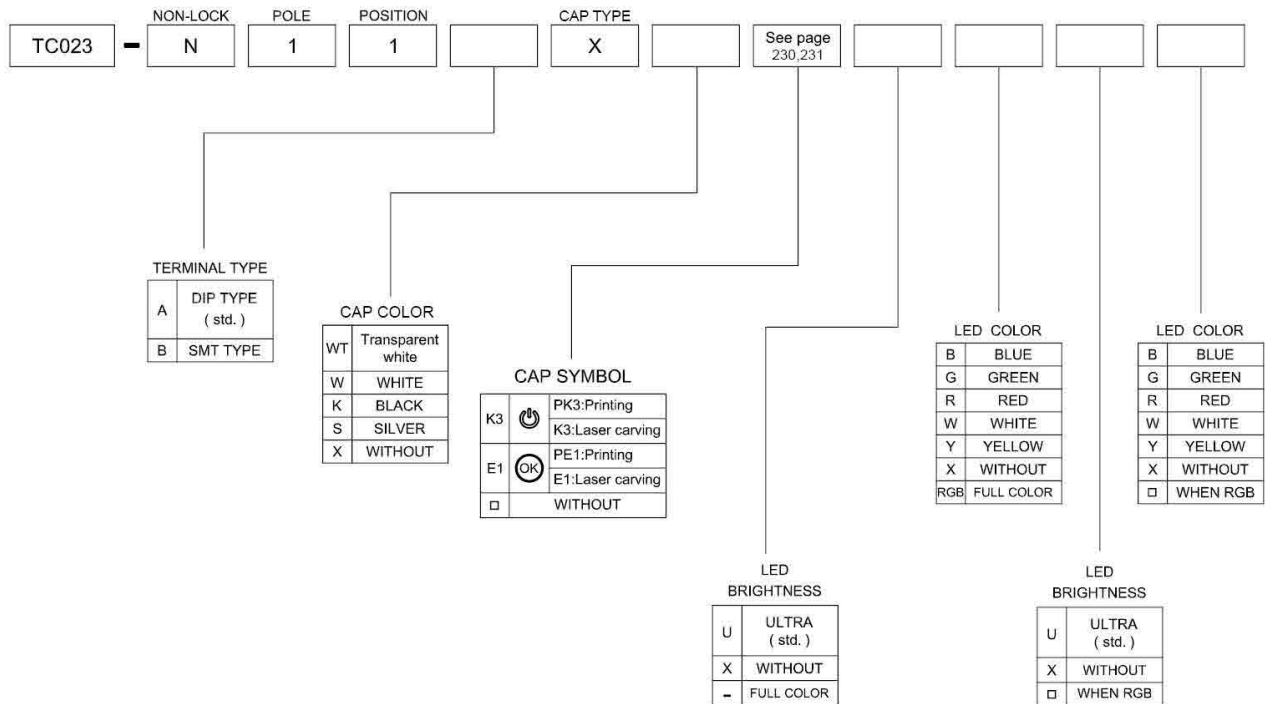

**TERMINAL TYPE**

• TC023-N11AXX□□□□

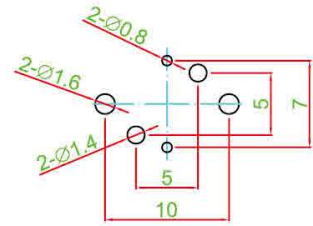
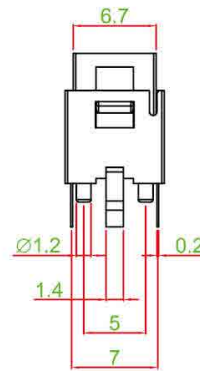
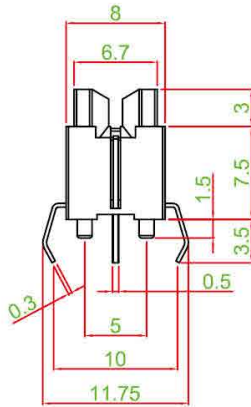

• TC023-N11BXX□□□□

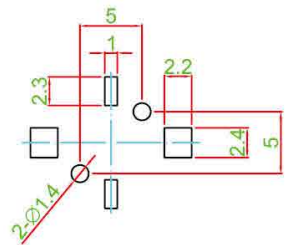
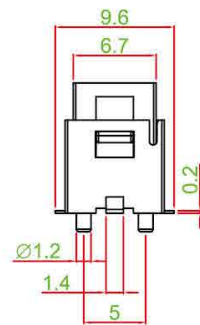
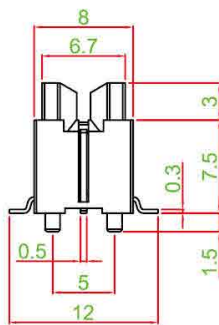

• TC023-N11AXX-RGB

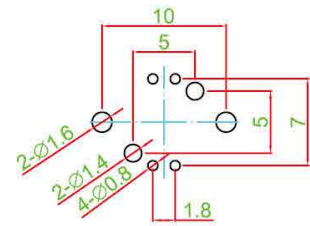
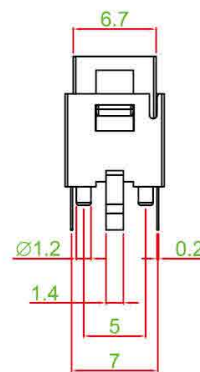
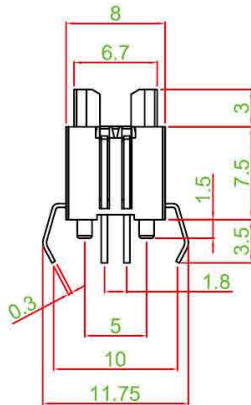

• TC023-N11BXX-RGB

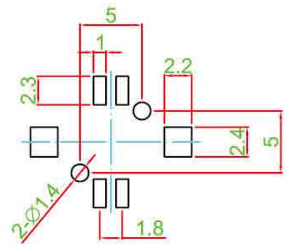
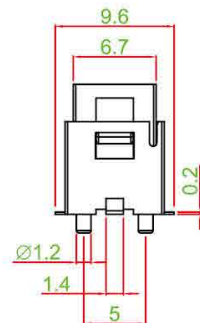
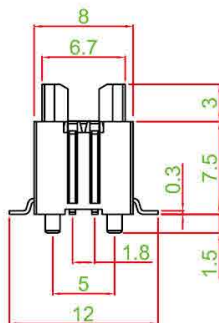

**CIRCUIT**

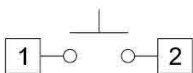

SINGLE COLOR

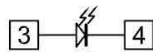

TWO COLOR

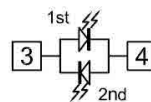

RGB COLOR

